

This drawing is © C4 Projects and is not to be copied, reproduced or re-distributed either in whole or in part without the prior written permission of the originator.

The originator shall have no responsibility for any liability, loss, cost, damage or expense arising from or relating to any use of this document other than for its intended purpose on this project.

This drawing shall be read in conjunction with all other relevant drawings, specifications and associated documentation. Any discrepancies, errors or omissions are to be reported to the originator before proceeding with work.

All dimensions are to be checked on site by the contractor prior to proceeding with any work. This drawing shall not be scaled to ascertain any dimensions, work to figured dimensions only.

**DISCLAIMER**  
When this drawing is issued in CAD, it is an uncontrolled version issued for information only, to enable the recipient to prepare their own documents/drawings for which they are solely responsible.

**SOFTWARE INTEROPERABILITY**  
C4 Projects prepared this drawing using Autodesk® REVIT Architecture.

C4 Projects does not accept liability for any loss or degradation of any information held in the drawing resulting from the translation from the original file format to any other file format or from the recipient's reading of it in any other programme.

Hazard Identification		
ref	hazard	date

Racking Schedule Option 1	
Type Mark	Count
Closed Bay Racking - 1100 x 2430mm	259

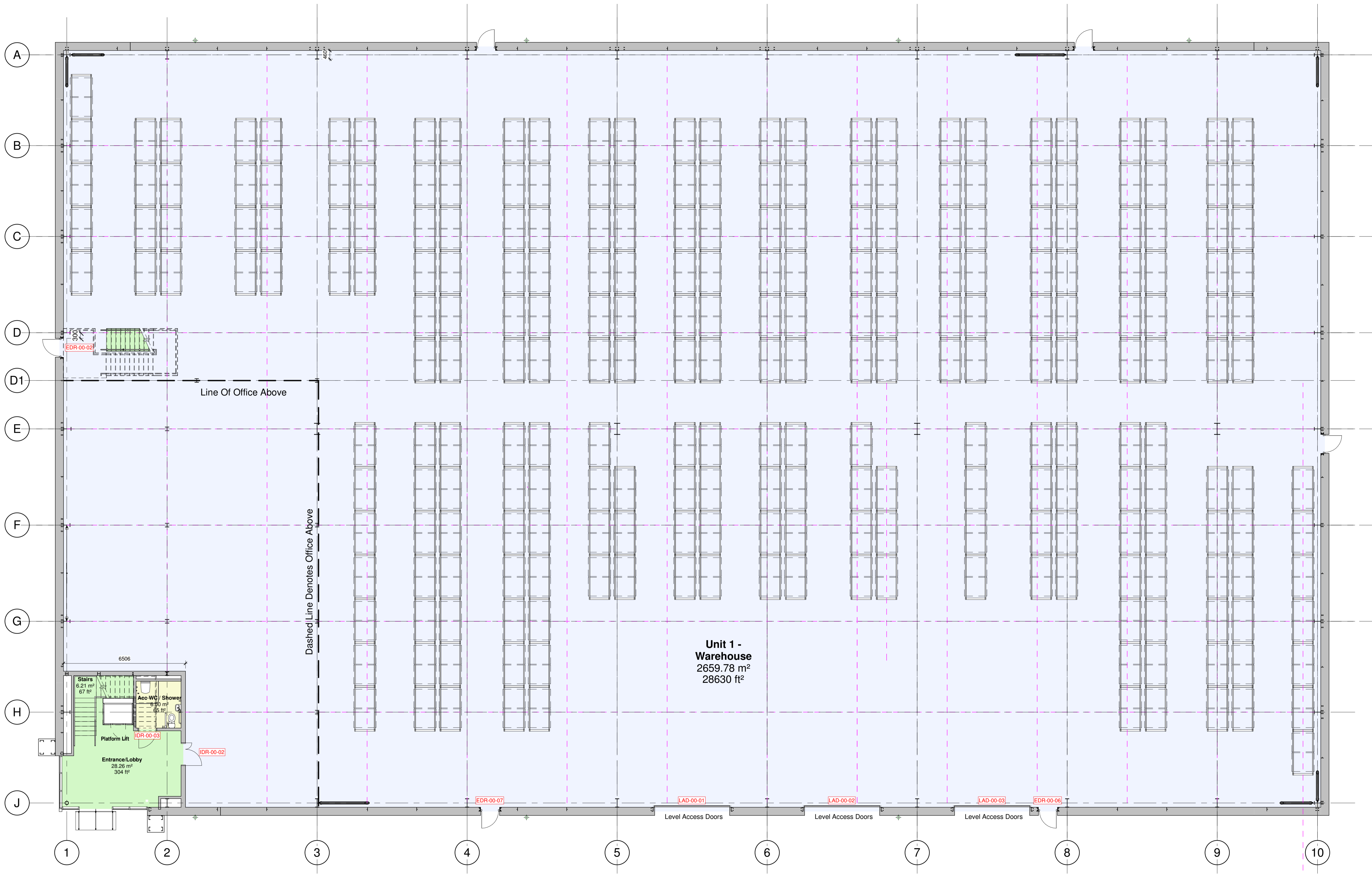

**Unit 1 - Warehouse**  
2659.78 m<sup>2</sup>  
28630 ft<sup>2</sup>

**1** 20-00- Racking Option 1-Level 00  
1:100

C01 First Issue	EK	21.04.22	CH
Rev	Revision Details	Drawn	Date

**C4 Projects**

Quayside,  
Widewater Business Park,  
Stockton Heath,  
Warrington,  
Cheshire,  
WA4 9JL  
t: 01925 751 852  
e: info@c4projects.co.uk  
www.c4projects.co.uk

Project Management • Architecture • Building Surveying • Cost Consultancy

**Client**  
Total Developments (NW) Ltd

**Project**  
Drake House Site  
Sheffield

**Drawing Title**  
Unit 1 - Racking Layout - Option 1

**Status Purpose of Issue**  
S2 SUITABLE FOR INFORMATION

Drawn by	EK	Created	21.04.2022
C4 Job no.	20031	Scale	1:100 @ A1

Dwg no.	20031-C4P-B1-00-DR-A-2002	Rev	C01
---------	---------------------------	-----	-----

This drawing is © C4 Projects and is not to be copied, reproduced or re-distributed either in whole or in part without the prior written permission of the originator.

The originator shall have no responsibility for any liability, loss, cost, damage or expense arising from or relating to any use of this document other than for its intended purpose on this project.

This drawing shall be read in conjunction with all other relevant drawings, specifications and associated documentation. Any discrepancies, errors or omissions are to be reported to the originator before proceeding with work.

All dimensions are to be checked on site by the contractor prior to proceeding with any work. This drawing shall not be scaled to ascertain any dimensions, work to figured dimensions only.

**DISCLAIMER**  
When this drawing is issued in CAD, it is an uncontrolled version issued for information only. To enable the recipient to prepare their own documents/drawings for which they are solely responsible.

**SOFTWARE INTEROPERABILITY**  
C4 Projects prepared this drawing using Autodesk REVIT Architecture.

C4 Projects does not accept liability for any loss or degradation of any information held in the drawing resulting from the translation from the original file format to any other file format or from the recipient's reading of it in any other programme.

Hazard Identification		
ref	hazard	date

Racking Schedule Option 2	
Type Mark	Count
Standard Bay 900x2880mm	189

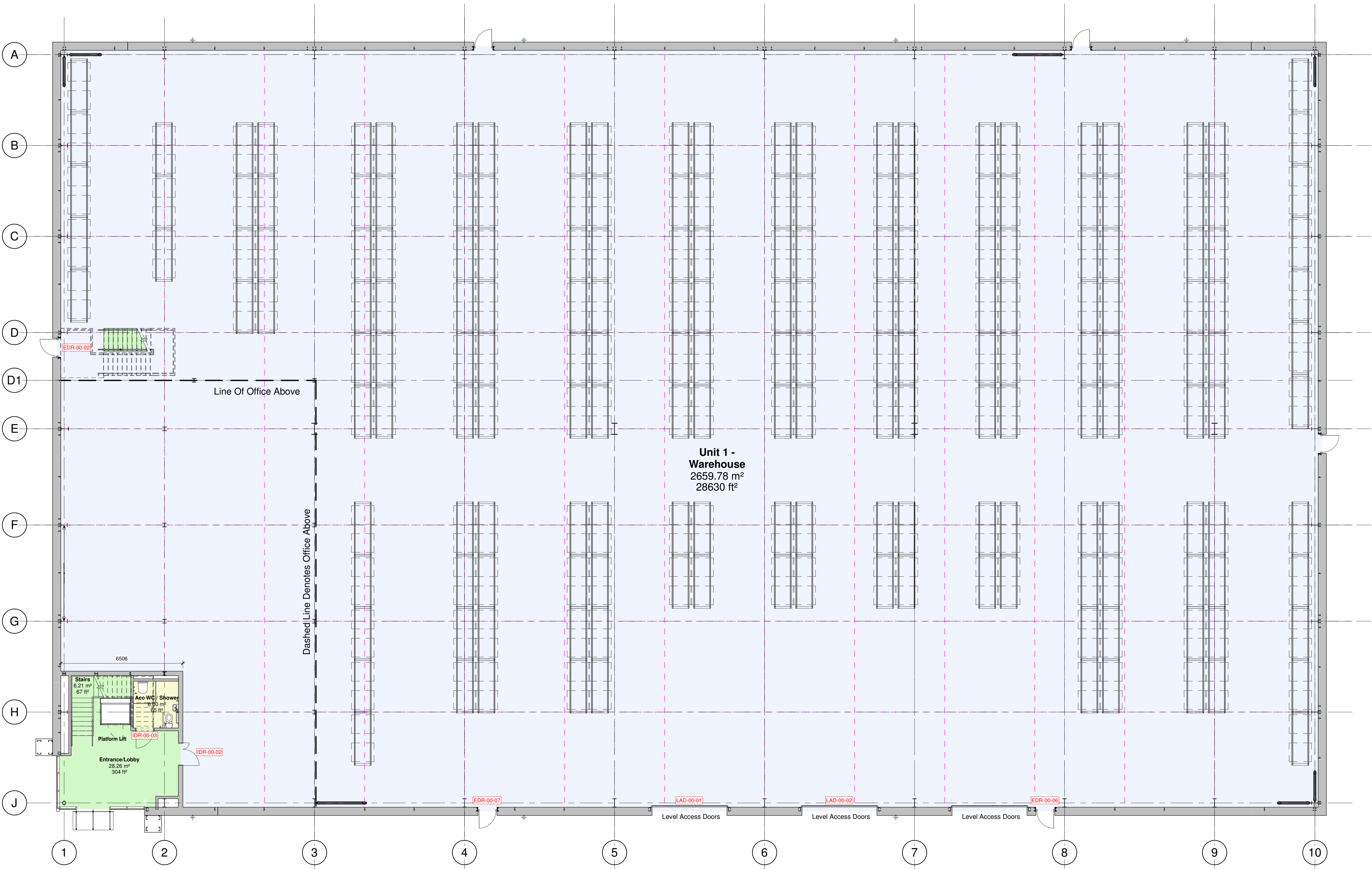

**Unit 1 - Warehouse**  
2659.78 m<sup>2</sup>  
28630 ft<sup>2</sup>

20-00- Racking Option 2-Level 00  
1:100

Rev	Revision Details	Drawn	Date	Checked
C01	First Issue	EK	21.04.22	CH

**C4 Projects**  
 Quayside, Widenspool Business Park, Stockton Heath, Warrington, Cheshire, WA4 6HL  
 t: 01925 751 852  
 e: info@c4projects.co.uk  
 www.c4projects.co.uk

Project Management • Architecture • Building Surveying • Cost Consultancy

Client  
Total Developments (NW) Ltd

Project  
Drake House Site  
Sheffield

Drawing Title  
Unit 1 - Racking Layout - Option 2

Status Purpose of Issue  
**S2 SUITABLE FOR INFORMATION**

Drawn by	EK	Created	21.04.2022
C4 Job no.	20031	Scale	1:100 @ A1

Dwg no.	20031-C4P-B1-00-DR-A-2003	Rev	C01
---------	---------------------------	-----	-----

**Drawing Status**

**INFORMATION**

This drawing is © C4 Projects and is not to be copied, reproduced or re-distributed either in whole or in part without the prior written permission of the originator.

The originator shall have no responsibility for any liability, loss, cost, damage or expense arising from or relating to any use of this document other than for its intended purpose on this project.

This drawing shall be read in conjunction with all other relevant drawings, specifications and associated documentation. Any discrepancies, errors or omissions are to be reported to the originator before proceeding with work.

All dimensions are to be checked on site by the contractor prior to proceeding with any work. This drawing shall not be scaled to ascertain any dimensions, work to figured dimensions only.

**DISCLAIMER**  
When this drawing is issued in CAD, it is an uncontrolled version issued for information only, to enable the recipient to prepare their own documents/drawings for which they are solely responsible.

**SOFTWARE INTEROPERABILITY**  
C4 Projects prepared this drawing using Autodesk REVIT Architecture.

C4 Projects does not accept liability for any loss or degradation of any information held in the drawing resulting from the translation from the original file format to any other file format or from the recipient's reading of it in any other programme.

Hazard Identification		
ref	hazard	date
Racking Schedule Option 1		
Type Mark	Count	
Closed Bay Racking - 1100 x 2430mm	204	

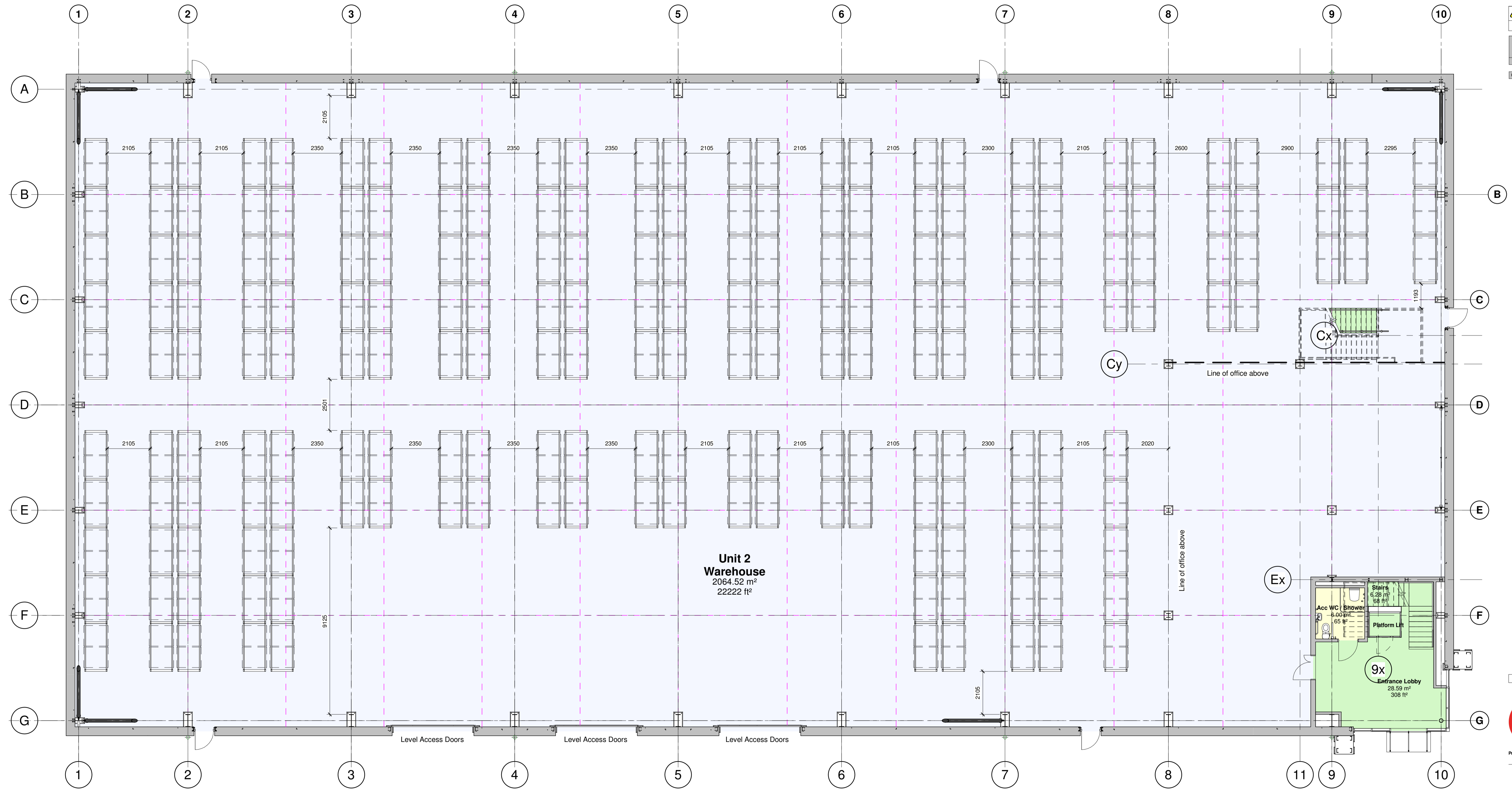

**Unit 2 Warehouse**  
2064.52 m<sup>2</sup>  
22222 ft<sup>2</sup>

20-00 Unit 2 Racking Option 1  
1:100

C01 First Issue	EK	21.04.22	CH
Rev	Revision Details	Drawn	Date

**C4 Projects**

Quayside, Widespool Business Park, Stockton Heath, Warrington, Cheshire, WA4 6GL  
t: 01925 751 852 e: info@c4projects.co.uk www.c4projects.co.uk

Project Management • Architecture • Building Surveying • Cost Consultancy

Client  
Total Developments (NW) Ltd

Project  
Drake House Site  
Sheffield

Drawing Title  
Unit 2 Racking Layout Option 1

Status Purpose of Issue  
**S2 SUITABLE FOR INFORMATION**

Drawn by	EK	Created	21.04.2022
C4 Job no.	20031	Scale	1:100 @ A1

Dwg no.	20031-C4P-B2-00-DR-A-2002	Rev	C01
---------	---------------------------	-----	-----

**Drawing Status**  
**INFORMATION**

This drawing is © C4 Projects and is not to be copied, reproduced or re-distributed either in whole or in part without the prior written permission of the originator.

The originator shall have no responsibility for any liability, loss, cost, damage or expense arising from or relating to any use of this document other than for its intended purpose on this project.

This drawing shall be read in conjunction with all other relevant drawings, specifications and associated documentation. Any discrepancies, errors or omissions are to be reported to the originator before proceeding with work.

All dimensions are to be checked on site by the contractor prior to proceeding with any work. This drawing shall not be scaled to ascertain any dimensions, work to figured dimensions only.

**DISCLAIMER**  
When this drawing is issued in CAD, it is an uncontrolled version issued for information only, to enable the recipient to prepare their own documents/drawings for which they are solely responsible.

**SOFTWARE INTEROPERABILITY**  
C4 Projects prepared this drawing using Autodesk REVIT Architecture.

C4 Projects does not accept liability for any loss or degradation of any information held in the drawing resulting from the translation from the original file format to any other file format or from the recipient's reading of it in any other programme.

Hazard Identification		
ref	hazard	date

Racking Schedule Option 2	
Type Mark	Count
Standard Bay 900x2880mm	128

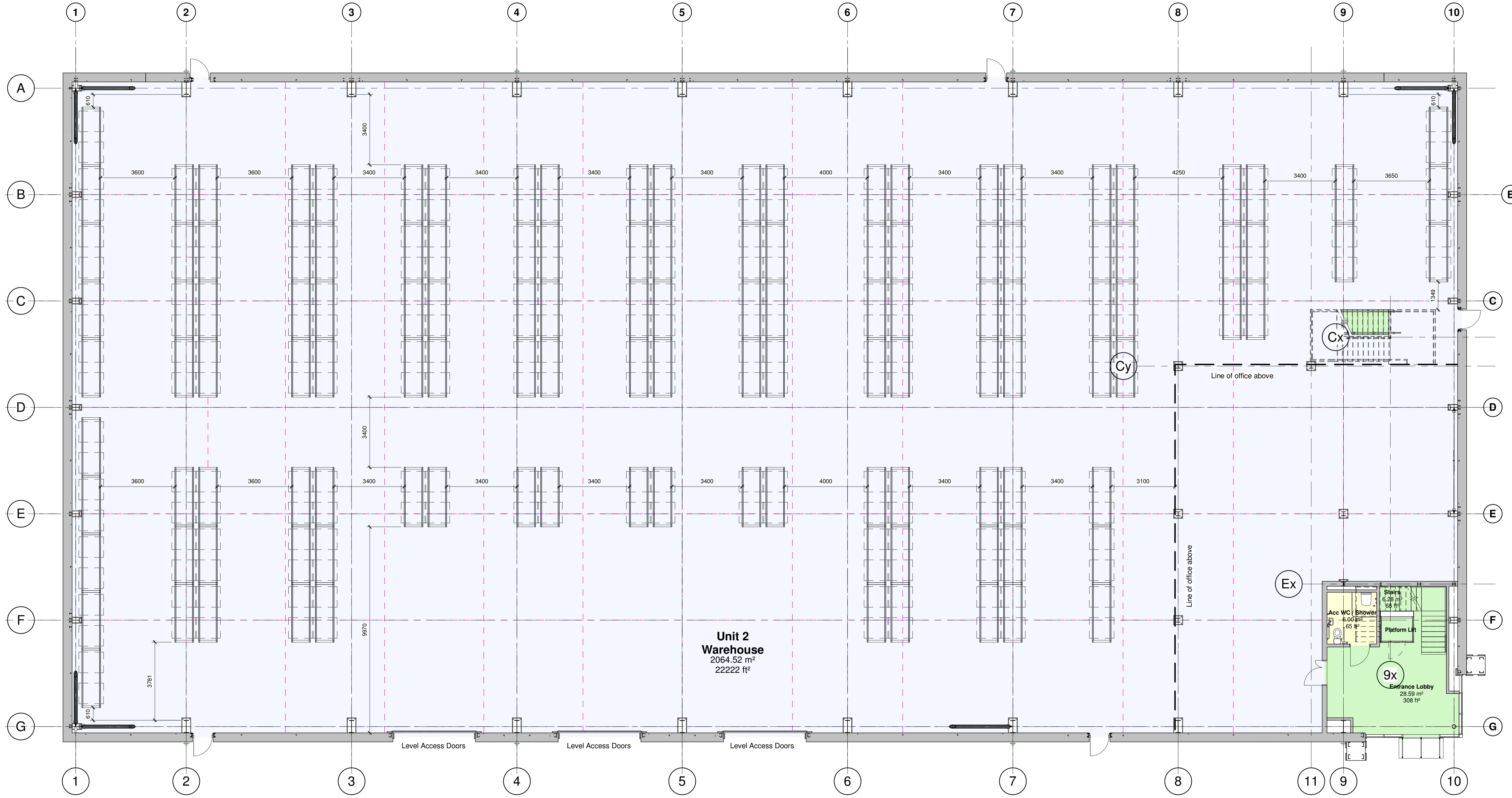

20-00 Unit 2 Racking Option 2  
1:100

Rev	Revision Details	Drawn	Date	Checked
C01	First Issue	EK	21.04.22	CH

**C4 Projects**  
 Outskirts, Widespool Business Park, Stockton Heath, Warrington, Cheshire, WA4 6HL  
 t: 01925 751 852  
 e: info@c4projects.co.uk  
 www.c4projects.co.uk

Project Management • Architecture • Building Surveying • Cost Consultancy

Client  
Total Developments (NW) Ltd

Project  
Drake House Site  
Sheffield

Drawing Title  
Unit 2 Racking Layout Option 2

Status Purpose of Issue  
**S2 SUITABLE FOR INFORMATION**

Drawn by EK Created 21.04.2022  
C4 Job no. 20031 Scale 1:100 @ A1

Dwg no.	Rev
20031-C4P-B2-00-DR-A-2003	C01

**Drawing Status**  
**INFORMATION**

This drawing is © C4 Projects and is not to be copied, reproduced or re-distributed either in whole or in part without the prior written permission of the originator.

The originator shall have no responsibility for any liability, loss, cost, damage or expense arising from or relating to any use of this document other than for its intended purpose on this project.

This drawing shall be read in conjunction with all other relevant drawings, specifications and associated documentation. Any discrepancies, errors or omissions are to be reported to the originator before proceeding with work.

All dimensions are to be checked on site by the contractor prior to proceeding with any work. This drawing shall not be scaled to ascertain any dimensions, work to figured dimensions only.

**DISCLAIMER**  
When this drawing is issued in CAD, it is an uncontrolled version issued for information only. To enable the recipient to prepare their own documents/drawings for which they are solely responsible.

**SOFTWARE INTEROPERABILITY**  
C4 Projects prepared this drawing using Autodesk REVIT Architecture.

C4 Projects does not accept liability for any loss or degradation of any information held in the drawing resulting from the translation from the original file format to any other file format or from the recipient's reading of it in any other programme.

Hazard Identification		
ref	hazard	date

Racking Schedule Option 1	
Type Mark	Count
Closed Bay Racking - 1100 x 2430mm	812

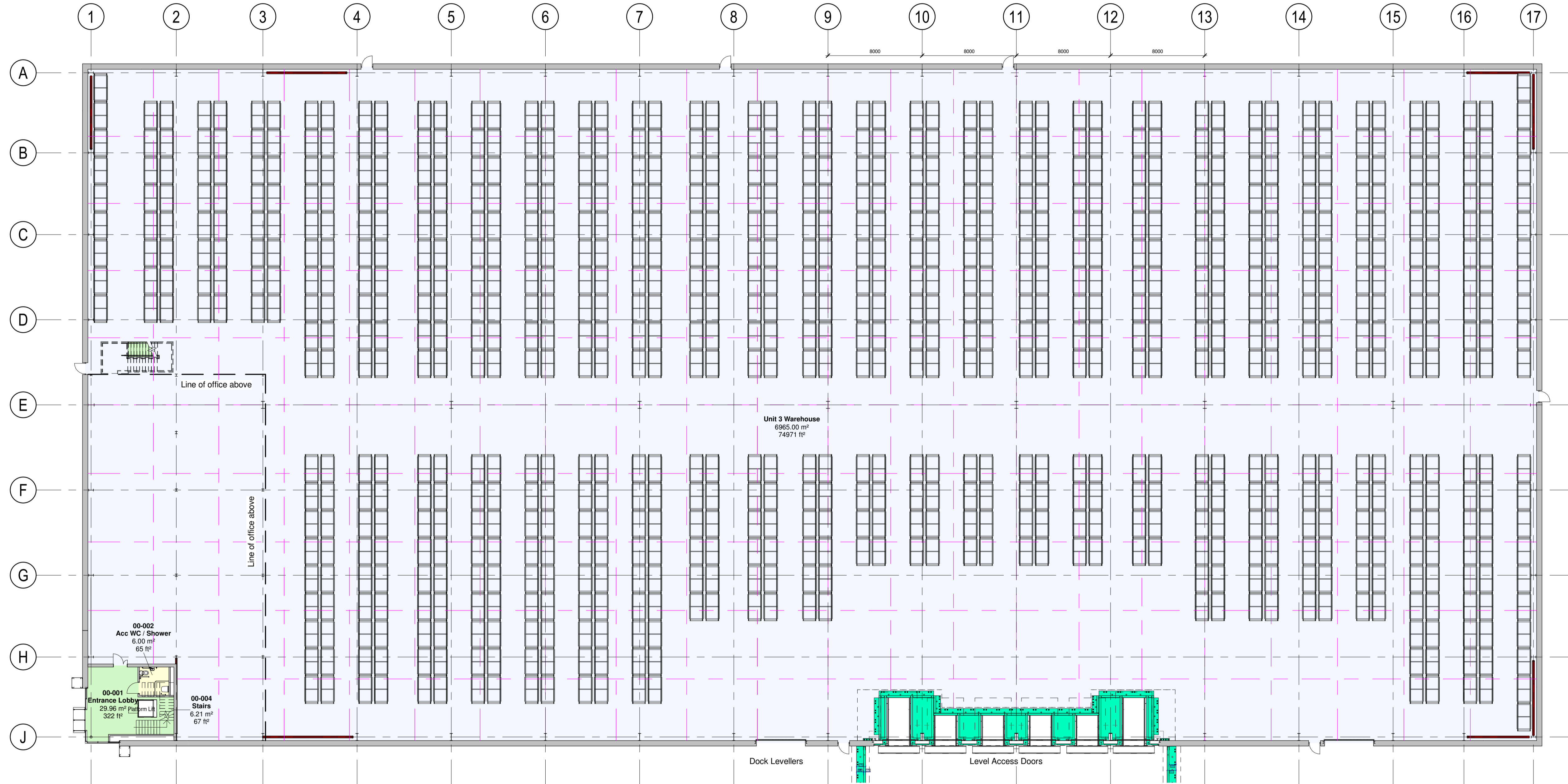

**20-00- Racking Option 1 - Level 00**  
1 : 200

C01 First Issue	EK	21.04.22	CH
Rev	Revision Details	Drawn	Date
			Checked

**C4 Projects**  
Outsiders,  
Widenspool Business Park,  
Stockton Heath,  
Warrington,  
Cheshire,  
WA4 6HL  
t: 01925 751 852  
e: info@c4projects.co.uk  
www.c4projects.co.uk

Project Management • Architecture • Building Surveying • Cost Consultancy

**Client**  
Total Developments (NW) Limited

**Project**  
Drake House Site  
Sheffield

**Drawing Title**  
Unit 3 Racking Layout - Option 1

**Status Purpose of Issue**  
S2 SUITABLE FOR INFORMATION

Drawn by	EK	Created	21.04.2022
C4 Job no.	20031	Scale	1 : 200 @ A1

Dwg no.	Rev
20031-C4P-B3-00-DR-A-2002	C01

**INFORMATION**

This drawing is © C4 Projects and is not to be copied, reproduced or re-distributed either in whole or in part without the prior written permission of the originator.

The originator shall have no responsibility for any liability, loss, cost, damage or expense arising from or relating to any use of this document other than for its intended purpose on this project.

This drawing shall be read in conjunction with all other relevant drawings, specifications and associated documentation. Any discrepancies, errors or omissions are to be reported to the originator before proceeding with work.

All dimensions are to be checked on site by the contractor prior to proceeding with any work. This drawing shall not be scaled to ascertain any dimensions, work to figured dimensions only.

**DISCLAIMER**  
When this drawing is issued in CAD, it is an uncontrolled version issued for information only. To enable the recipient to prepare their own documents/drawings for which they are solely responsible.  
**SOFTWARE INTEROPERABILITY**  
C4 Projects prepared this drawing using Autodesk REVIT Architecture.  
C4 Projects does not accept liability for any loss or degradation of any information held in the drawing resulting from the translation from the original file format to any other file format or from the recipient's reading of it in any other programme.

Hazard Identification		
ref	hazard	date

Racking Schedule Option 2	
Type Mark	Count
Standard Bay 900x2880mm	550



Rev	Revision Details	Drawn	Date	Checked

**C4 Projects**  
 Quayside, Widespool Business Park, Stockton Heath, WAA 6HL  
 t: 01525 751 852  
 e: info@c4projects.co.uk  
 www.c4projects.co.uk

Project Management • Architecture • Building Surveying • Cost Consultancy

Client  
Total Developments (NW) Limited

Project  
Drake House Site  
Sheffield

Drawing Title  
Unit 3 Racking Layout - Option 2

Status Purpose of Issue  
**S2 SUITABLE FOR INFORMATION**

Drawn by	EK	Created	21.04.2022
C4 Job no.	20031	Scale	1:200 @ A1

Dwg no.	20031-C4P-B3-00-DR-A-2003	Rev	C01
---------	---------------------------	-----	-----

20-00- Racking Option 2 - Level 00  
1:200